



SUBJECT:

Required maintenance for Standard Interior Modification, Bush Seat Cushion
(P/N 350-701044).

APPLICABILITY :

Aircraft with the subject modification embodied in accordance with TCCA STC
No. SH12-28 or any relevant foreign approvals.

THE INFORMATION CONTAINED IN THIS DOCUMENT SHALL BE TREATED AS THE PROPERTY OF EUROCOPTER CANADA LIMITED (ECL). THE RECIPIENT OF THIS DOCUMENT SHALL NOT DISCLOSE ANY INFORMATION CONTAINED HEREIN TO THIRD PARTIES WITHOUT THE WRITTEN PERMISSION OF ECL, AND SHALL NOT USE OR REPRODUCE THIS DOCUMENT IN WHOLE OR IN PART FOR ANY PURPOSE OTHER THAN ITS ORIGINALLY INTENDED PURPOSE, OR TO EVALUATE ITS CONTENTS.

	NAME AND SIGNATURE	DATE	COMPANY DEPARTMENT
PREPARED BY:	D. Kerr <i>D Kerr</i>	30 March 2012	ECL ENGINEERING
PREPARED BY:			
CHECKED BY:	C. Timmins <i>C. Timmins</i>	30 March 2012	ECL ENGINEERING
CHECKED BY:	M. Merritt <i>for M. Merritt</i>	30 March 12	ECL QUALITY ASSURANCE
APP'D / ACCEPTED (Civil A/W Authority)	As per ICA Compliance Check Sheet <i>C. Timmins</i>	11 th April 2012	TCCA
RELEASED BY:	R. Manson <i>R Manson</i>	11 Apr '12	ECL ENGINEERING

CONTENTS

SECTION	TITLE	PAGE
1	GENERAL	4
2	AIRWORTHINESS LIMITATIONS	12
3	CONTROL AND OPERATION	13
4	INSPECTION SCHEDULE AND MAINTENANCE ACTION	13
5	REPLACEMENT COMPONENTS AND REPAIR / OVERHAUL INFORMATION	14
6	TROUBLESHOOTING	14
7	SPECIAL TOOLING	14
8	REMOVAL AND REPLACEMENT	15
9	WEIGHT AND BALANCE DATA	16
10	PLACARDS AND MARKINGS	16
Appendix A	Interior Modification drawing (1 page)	
Appendix B	Vinyl Seat Cover cleaning information (1 page)	

FIGURES

FIGURE	TITLE	PAGE
1	General Layout	5
2	Forward Bush Seat Cushion Details (Sheet 1 of 2)	6
3	Forward Bush Seat Cushion Details (Sheet 2 of 2)	7
4	Rear Bush Seat Cushion Details (Sheet 1 of 3)	8
5	Rear Bush Seat Cushion Details (Sheet 2 of 3)	9
6	Rear Bush Seat Cushion Details (Sheet 3 of 3)	10

TABLES

TABLE	TITLE	PAGE
1	Inspection Schedule and Maintenance Action For AS 350 D, B, BA, B1 Every 100 flight hrs or 12 months, whichever occurs first	13
	For AS 350 B2/B3 Every 150 flight hrs or 12 months, whichever occurs first	13

1. **GENERAL**

- A. The subject Standard Interior Modification for the Bush Seat Cushion is defined by ECL drawing number 350-701044 and consists of the following OEM seat cushion configurations:

Description	Part Number	Appendix Number
Forward Seat Cushion P/N F0428848	see drawing number 350-701044- 01	Appendix A, B
Rear Seat Back Cushion P/N 350A771412.11	see drawing number 350-701044- 02	Appendix A, B
Rear Seat Back Cushion P/N 350A771412.12	see drawing number 350-701044- 03	Appendix A, B
Rear Seat Bottom Cushion P/N 350A771412.10	see drawing number 350-701044- 06	Appendix A, B

The forward and rear bush cushions are all manufactured from OEM foam covered in vinyl. These cushions may be utilized as an alternate to the standard seat cushions.

The forward bush cushions are manufactured to fit the energy absorbing seat frame and secured to the seat frame using snaps and velcro hook and loop.

Two strap holders manufactured from vinyl are attached to the back of the rear bush cushion cover. Two OEM cushion security straps feed through the strap holders securing the rear back seat cushions to the cabin wall. Velcro loop on the back of each rear back cushion secures the cushion to the existing velcro hook on the back wall. The cushion security straps and velcro hook and loop are used to prevent the rear cushions from exiting the aircraft when operating the aircraft with the doors open or removed.

The rear back and bottom cushions are secured together using Velcro. The rear bottom cushions are secured to the seat frame using velcro hook and loop.

Refer to Figure 1 for General Layout.

- B. These Instructions for Continued Airworthiness are applicable to aircraft with the subject modification embodied.

1. **GENERAL** (continued)

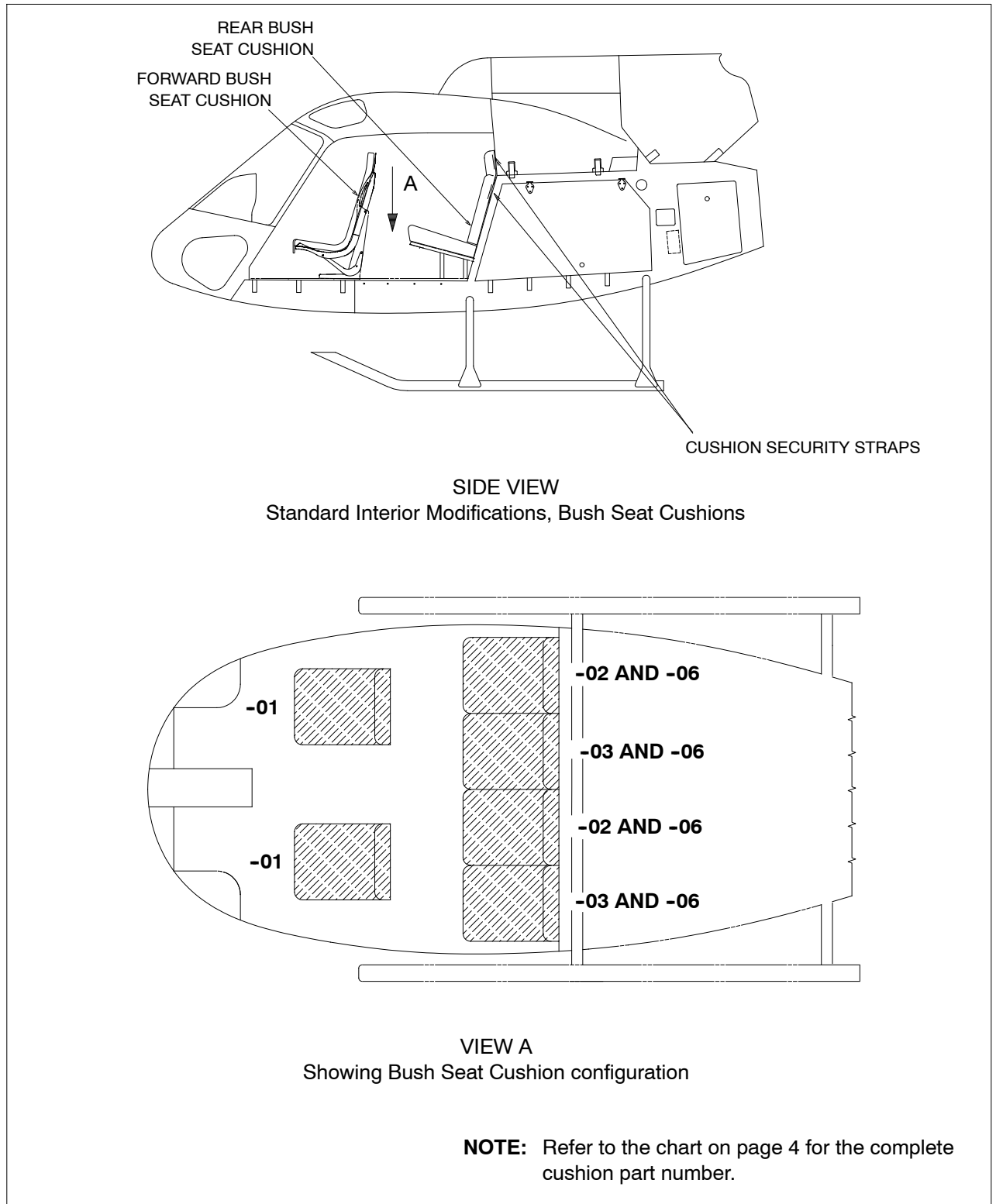

Figure 1 General Layout

Transport Canada - Accepted

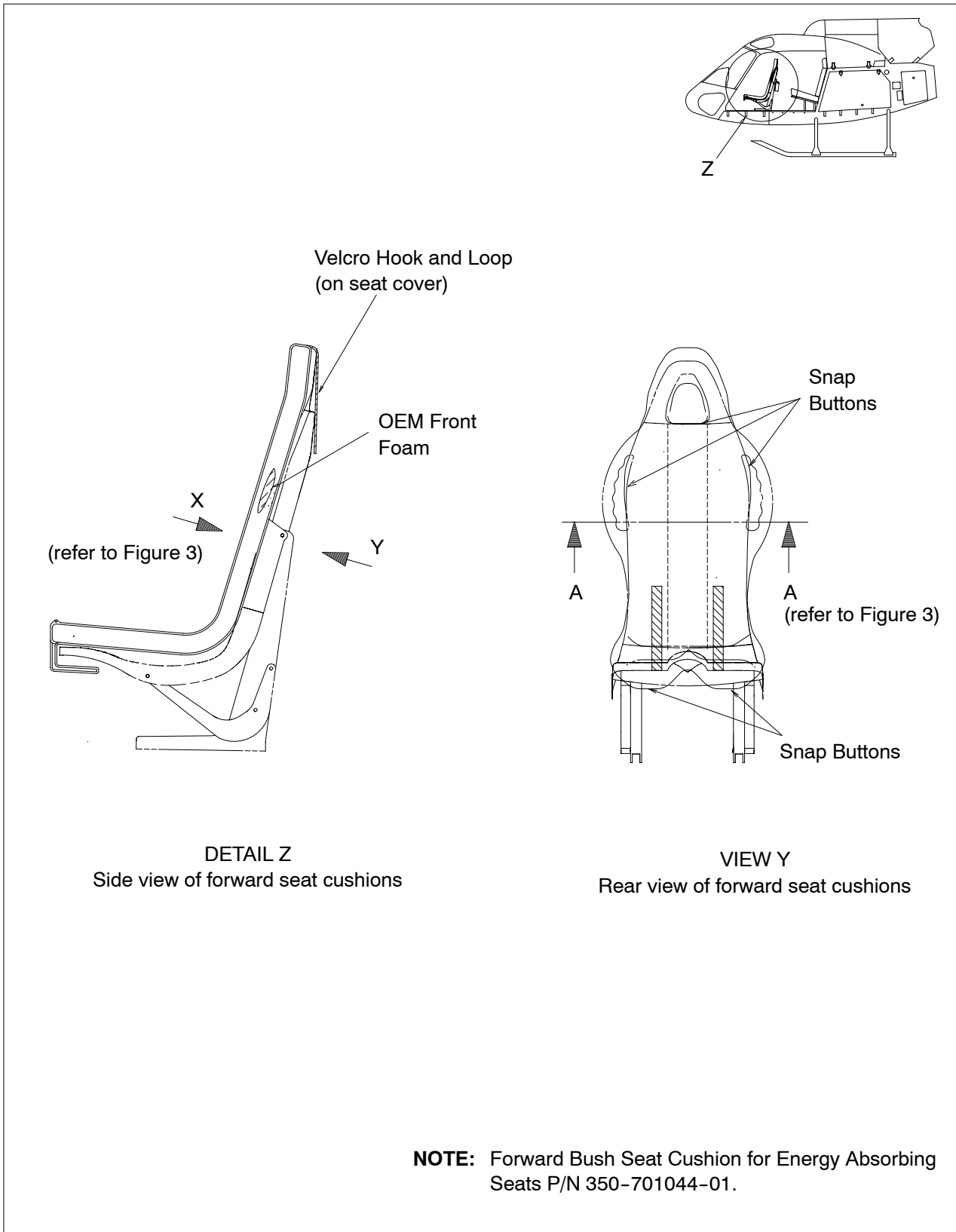

Figure 2 Forward Bush Seat Cushion Details (Sheet 1 of 2)

Transport Canada - Accepted



Legend (for Figure 3)

Item Description

- 1. Vinyl Seat Cover
- 2. Snap Buttons

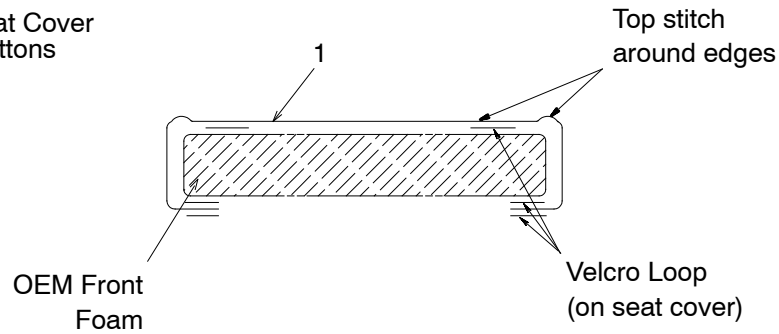

SECTION A - A
Showing Forward Seat Cushion

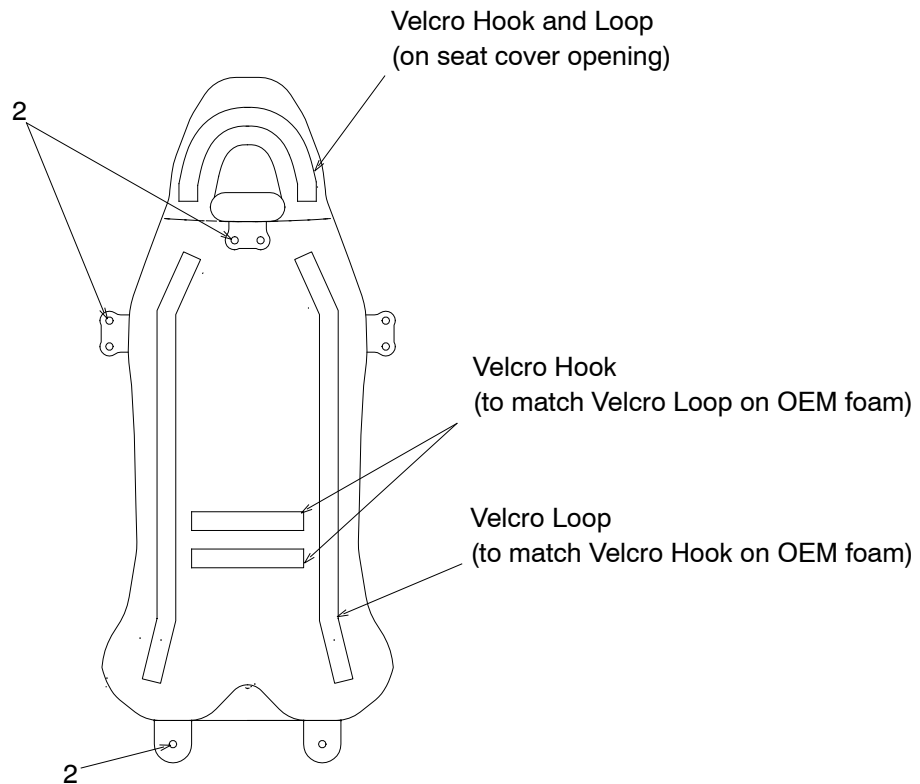

VIEW X
Showing inside Forward Seat Cushion

Figure 3 Forward Bush Seat Cushion Details (Sheet 2 of 2)

Transport Canada - Accepted

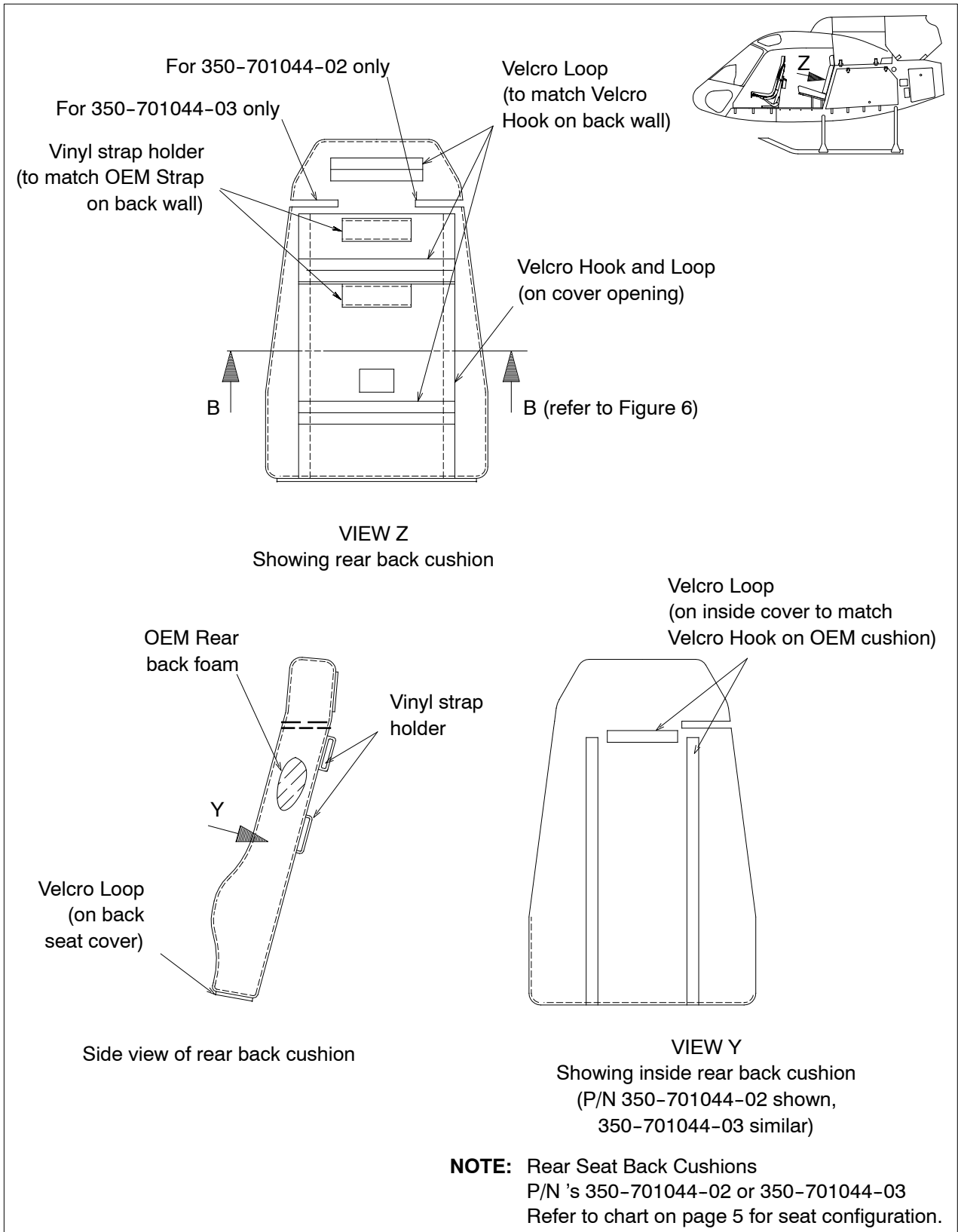

Figure 4 Rear Bush Seat Cushion Details (Sheet 1 of 3)

Transport Canada - Accepted

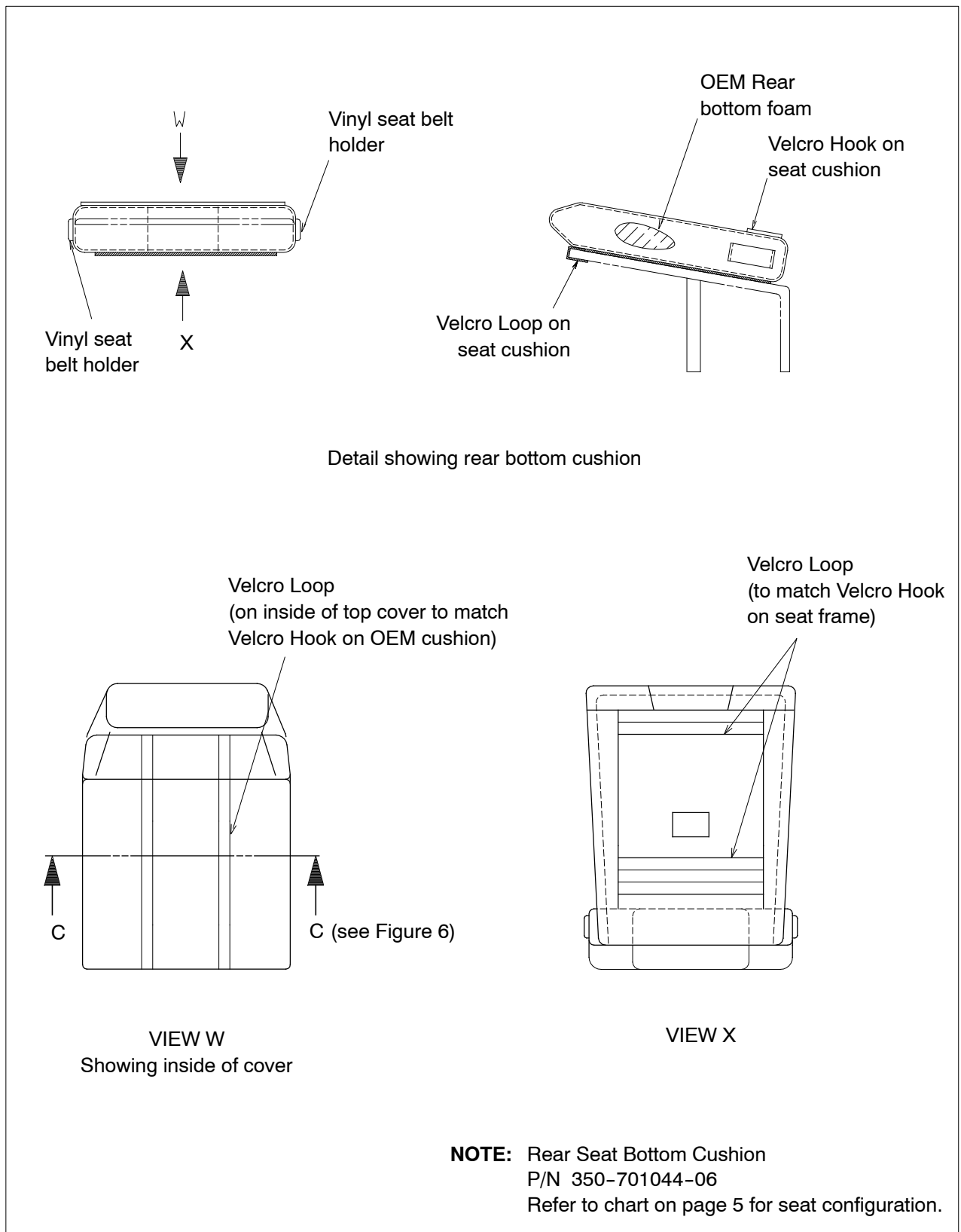

Figure 5 Rear Bush Seat Cushion Details (Sheet 2 of 3)

Transport Canada - Accepted

Legend (for Figure 6)

Item Description

1. Vinyl Seat Cover
2. OEM Rear Bottom Foam or OEM Rear Back Foam

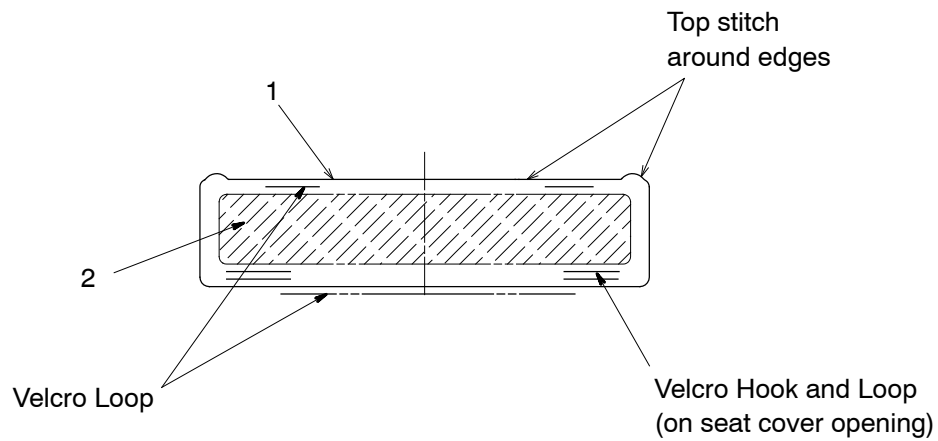

SECTION B - B
SECTION C - C
Showing rear bottom or back cushion

Figure 6 Rear Bush Seat Cushion Details (Sheet 3 of 3)

Transport Canada - Accepted

C. REFERENCES

DOCUMENT	DOCUMENT TITLE
AMM (B2/B3)	Aircraft Maintenance Manual
MTC (All aircraft)	Standard Practices Manual

D. ABBREVIATIONS & DEFINITIONS

ABBREVIATION	DEFINITION
EC	Eurocopter (France)
ECL	Eurocopter Canada Limited
hrs.	hours
OEM	Original Equipment Manufacturer
P/N	Part Number
ref.	reference

E. UNITS OF MEASUREMENT

ABBREVIATION / SYMBOL	UNIT OF MEASUREMENT
kg	kilogram
lb	pound
m	meter
mm	millimeters
in	inch

Transport Canada - Accepted

2. AIRWORTHINESS LIMITATIONS

The Airworthiness Limitations section is approved by the Minister and specifies maintenance required by any applicable airworthiness or operating rule unless an alternative program has been approved by the Minister.

No airworthiness limitations associated with this installation.

3. CONTROL AND OPERATION

Control and operation of the aircraft remains unchanged.

4. INSPECTION SCHEDULE AND MAINTENANCE ACTION

NOTE: Use torque per EC MTC, Volume 2, Chapter 20.02.05.404, unless otherwise specified.

4.1. INSPECTION SCHEDULE

4.1.1. For AS 350 D, B, BA, B1

Every 100 flight hrs or 12 months (to coincide with the 100 hrs or 12 months helicopter inspection) whichever occurs first:

For AS 350 B2/B3

Every 150 flight hrs or 12 months (to coincide with the 150 hrs or 12 months helicopter inspection) whichever occurs first:

ITEM	INSPECTION OR MAINTENANCE WORK	CORRECTIVE ACTION
A	- Check cushion security straps on back wall, shown in Figure 1, for: a. security	a. Secure as required.
B	- Visually inspect snaps on forward and seat cushion coverings, shown in Figure 2 for: a. security	a. Secure button snaps as required.
C	- Visually inspect strap holder on back of each rear seat, shown in Figure 4, for: a. separating	a. Check that strap is not separating from seat cushion. If so, contact Eurocopter Canada Limited for replacement parts.
D	- Check vinyl seat cushion covering, item 1, in Figures 3 and 5, for: a. tearing b. cleanliness	a. Check that foam/backing is not exposed. If so, contact Eurocopter Canada Limited. b. For cleaning instructions, refer to Appendix B.

Table 1 Inspection Schedule and Maintenance Action
Every 100 flight hrs or 12 months, whichever occurs first (AS 350 D, B, BA, B1)
Every 150 flight hrs or 12 months, whichever occurs first (AS 350 B2/B3)
(continued on following page)

4. INSPECTION SCHEDULE AND MAINTENANCE ACTION (continued)

4.1. INSPECTION SCHEDULE

- 4.1.1. For AS 350 D, B, BA, B1
Every 100 flight hrs or 12 months (to coincide with the 100 hrs or 12 months helicopter inspection) whichever occurs first:
For AS 350 B2/B3
Every 150 flight hrs or 12 months (to coincide with the 150 hrs or 12 months helicopter inspection) whichever occurs first:

ITEM	INSPECTION OR MAINTENANCE WORK	CORRECTIVE ACTION
E	<ul style="list-style-type: none"> - Visually inspect velcro hook and loop on vinyl seat cushion covers shown in Figures 2, 3, 4, 5 and 5 for: <ul style="list-style-type: none"> a. wear b. security 	<ul style="list-style-type: none"> a. Wear is not permitted. If wear is evident, replace velcro in accordance with: For AS 350 (excluding the B2 and B3) refer to MTC Chapter 20.03.04.406. For AS 350 B2 and B3 refer to EC AMM Chapter 25-21-00, 8-4. Refer to Appendix A for replacement Part Number. b. Secure as required.

Table 1 Inspection Schedule and Maintenance Action
Every 100 flight hrs or 12 months, whichever occurs first (AS 350 D, B, BA, B1)
Every 150 flight hrs or 12 months, whichever occurs first (AS 350 B2/B3)

5. REPLACEMENT COMPONENTS AND REPAIR / OVERHAUL INFORMATION

No replacement components and repair/overhaul information required for this installation.

6. TROUBLESHOOTING

There are no unique characteristics which require troubleshooting techniques.

7. SPECIAL TOOLING

No special test equipment or tools are required. Standard tools are adequate.

8. REMOVAL AND REPLACEMENT

Proceed as follows if any of these items need to be removed.

PRELIMINARIES

- Remove standard seat cushions and store.

A. REMOVAL

- 1) FWD SEAT CUSHIONS (Refer to Figure 2)
 - a) Unsnap cushions from seat frame.
 - b) Remove cushions from pilot and co-pilot seat frames.
- 2) REAR SEAT CUSHIONS (Refer to Figures 4 and 5)
 - a) Remove cushion security straps from the vinyl strap holders on the seat back cushions.
 - b) Remove the seat back cushions and seat bottom cushions from the rear seat frames.

B. REPLACEMENT

- 1) FWD SEAT CUSHIONS (Refer to Figure 2)
 - a) Position seat cushions and secure using Velcro hook and loop and snaps.
- 2) REAR SEAT CUSHIONS (Refer to Figures 4 and 5)
 - a) Position the seat back and bottom cushions in the aircraft. Feed the cushion security straps through the vinyl strap holders located on the back of the back seat cushions. Refer to Figure 4, VIEW Z.
 - b) Secure seat back and bottom cushions using Velcro Hook and Loop. Refer to Figures 4 and 5.

9. WEIGHT AND BALANCE DATA

A. Removed Items - OEM Seat Cushions

DESCRIPTION	WEIGHT		ARM		MOMENT	
	kg	lbs	m	in	kg m	lb in
Standard Forward Seat Cushions (2 seats)	4.00	8.8	1.57	61.8	6.28	543.8
Standard Passenger Seat Cushions (4 seats)	11.35	25.0	2.50	98.4	28.38	2460.0
Total	15.35	33.8	2.26	88.9	34.66	3003.8

B. Added Items - Bush Seat Cushions

DESCRIPTION	WEIGHT		ARM		MOMENT	
	kg	lbs	m	in	kg m	lb in
Forward Seat Cushions (2 seats)	5.70	12.6	1.57	61.8	8.95	778.7
Rear Seat Back and Bottom Cushions (4 seats)	14.18	31.3	2.50	98.4	35.45	3079.9
Total	19.88	43.9	2.23	87.9	44.40	3858.6

10. PLACARDS AND MARKINGS

There are no placards and markings with this installation.

Transport Canada - Accepted

TEXHYDE

Leather Look with Textile Softness

PREMIER

PREMIER has been developed to meet the rigorous demands of hospital, contract, and institutional use. PREMIER is designed for all covering requirements and exceeds the accepted industry standards for upholstery products.

PREMIER is ideally suited for commercial and contract upholstery applications, as well as residential:

- office
- lounge
- hospitals
- nursing homes
- family rooms
- restaurant
- hotel/motel
- hair salons
- living room
- casual dining

PREMIER is formulated to meet the flammability requirements contained in the following specifications:

- Federal Specification AA-2950A (Supercede CCCA680a)
- NFPA 701, Small Scale Test
- NFPA 260 A, Class 1
- Boston Fire Code (BFD IX-1)
- Designed to pass FAA 25.853
- Contact our Sales Representative for details
- Port Authority of NY & NJ
- California Fire Regulation (Bulletin 117-Section E)
- Motor Vehicle Safety Standard No. 302
- UFAC Class 1
- BIFMA

*NOTE: Terms and corresponding data refer to performance in the specific test indicated and should not be construed to imply the behavior of this or any other material under actual fire conditions.

TECHNICAL DATA

- Width: 54 inches
- Weight: 40 ounces per linear yard
- Roll Length: 30 yards
- Sulfide stain resistant
- Oil resistant
- -20 degree F. cold crack
- Abrasion Resistance - 100,000 double rubs, Wyzenbeek ASTM 04157
- Anti static slip finish
- Ultraviolet resistant
- Mildew and bacteria resistant (ASTM G21-70 & G22-76)
- Heat sealable
- Excellent cleansability
- Excellent seam strength

ADDITIONAL INFORMATION AND CLEANING INSTRUCTIONS:

PREMIER is specially formulated to resist the following bacteria, and many others, when tested using the AATC method 147-1988: *Aspergillus Niger*; *Penicillium Pinophilum*; *Chaetomium Globosum*; *Aureobasidium Pullulans*; *Trichoderma sp.*; *Pseudomonas Aeruginosa*; *Staphylococcus Aureus*; and *Klebsiella Pneumoniae*.

Cleaning Instructions: Ordinary dirt and stains can be removed with mild soap and water. Rinse the cleaned area with clear water and dry with a soft, lint free cloth. As with all stains, prompt cleaning is recommended. PREMIER will resist, without serious discoloration, the repeated action of normal dilutions of chlorine bleaches or ammonia based cleaners used for sterilization and cleaning in medical environments.

ORDERS

- When placing orders please indicate:
- 1) Grade - Premium Grade Expanded
 - 2) Pattern Name - Premier
 - 3) Pattern Number - BA 636
 - 4) Color Name and Number

